

## Artikel von A-Z



### Inhaltsverzeichnis

|   |   |
|---|---|
| <b>1 V5</b> .....                               | 1 |
| <b>2 V7</b> .....                               | 2 |
| <b>3 V15</b> .....                              | 2 |
| <b>4 V21</b> .....                              | 2 |
| <b>5 Software</b> .....                         | 2 |
| 5.1 <b>ETISS</b> .....                          | 2 |
| 5.2 <b>ETISS NG</b> .....                       | 3 |
| 5.3 <b>ETISS ERP</b> .....                      | 3 |
| 5.4 <b>ETISS Global</b> .....                   | 3 |
| 5.5 <b>ETISS Kantine Benutzerhandbuch</b> ..... | 3 |
| 5.6 <b>ETOSS</b> .....                          | 3 |
| 5.7 <b>Einrichtungsassistent</b> .....          | 4 |
| <b>6 Gate</b> .....                             | 4 |
| 6.1 <b>Galaxy-Gate</b> .....                    | 4 |
| <b>7 Akku</b> .....                             | 4 |
| 7.1 <b>Li-ion Battery</b> .....                 | 4 |
| <b>8 KT-Drive</b> .....                         | 4 |
| 8.1 <b>KT Drive</b> .....                       | 5 |
| <b>9 POS</b> .....                              | 5 |
| 9.1 <b>POS</b> .....                            | 5 |
| <b>10 Kamberi Group</b> .....                   | 5 |
| 10.1 <b>Kamberi Group</b> .....                 | 5 |

### Vending Unit





#### V5

- VendingUnit ~ V5 ~ Benutzerhandbuch

|   |  |
|---|--|
|    | <p><b>V7</b></p>   |
|    | <ul style="list-style-type: none"> <li>■ <a href="#">VendingUnit ~ V7 ~ EasyGO ~ user manual</a></li> <li>■ <a href="#">VendingUnit ~ V7 ~ VU trolley ~ user manual</a></li> <li>■ <a href="#">VendingUnit ~ V7 ~ Bedienvideos</a></li> <li>■ <a href="#">VendingUnit ~ V7 ~ Softwareanleitung</a></li> <li>■ <a href="#">VendingUnit ~ V7 ~ Troubleshooting ~ Störung: Automat ist außer Betrieb</a></li> </ul> |
|   | <p><b>V15</b></p> <ul style="list-style-type: none"> <li>■ <a href="#">VendingUnit ~ V15 ~ user manual</a></li> </ul>  |
|  | <p><b>V21</b></p> <ul style="list-style-type: none"> <li>■ <a href="#">VendingUnit ~ V21 ~ Prospekte</a></li> <li>■ <a href="#">VendingUnit ~ V21 ~ hopper management</a></li> <li>■ <a href="#">VendingUnit ~ V21 ~ Hoppermanagement</a></li> <li>■ <a href="#">VendingUnit/V21/Bedienvideos</a></li> </ul>   |

**Software**

|   |   |
|---|---|
|  | <p><b>ETISS</b></p>   |
|   | <ul style="list-style-type: none"> <li>■ <a href="#">ETISS ~ Informationsbroschüre</a></li> </ul> |

|   |  |
|---|--|
|    | <p><b>ETISS NG</b></p> <hr/> <ul style="list-style-type: none"> <li>▪ <a href="#">ETISS NG ~ Client Bedienungsanleitung</a></li> </ul>   |
|   | <p><b>ETISS ERP</b></p> <hr/> <ul style="list-style-type: none"> <li>▪ <a href="#">Backend Frontend ~ ETISS ERP ~ Elektronischer Pfortner</a></li> <li>▪ <a href="#">Backend Frontend ~ ETISS ERP ~ Lager Inventur</a></li> <li>▪ <a href="#">Backend Frontend ~ ETISS ERP ~ Reporting</a></li> <li>▪ <a href="#">Backend Frontend ~ ETISS ERP ~ Reporting v10</a></li> <li>▪ <a href="#">Backend Frontend ~ ETISS ERP ~ Verkauf. Angebot anlegen</a></li> <li>▪ <a href="#">ETISS ERP ~ Backend Bedienungsanleitung</a></li> <li>▪ <a href="#">Backend Frontend ~ ETISS ERP ~ Datasheet</a></li> <li>▪ <a href="#">ETISS ERP ~ POS Bedienungsanleitung</a></li> </ul> |
|   | <p><b>ETISS Global</b></p> <hr/> <ul style="list-style-type: none"> <li>▪ <a href="#">ETISS Global ~ Bedienungsanleitung</a></li> <li>▪ <a href="#">ETISS Global ~ Benutzerhandbuch</a></li> </ul>   |
|   | <p><b>ETISS Kantine Benutzerhandbuch</b></p> <hr/> <ul style="list-style-type: none"> <li>▪ <a href="#">Artikel von A-Z</a></li> <li>▪ <a href="#">ETISS Kantine Benutzerhandbuch</a></li> </ul>   |
|  | <p><b>ETOSS</b></p> <hr/>  |



## Einrichtungsassistent

- Bedienungsanleitung

## Gate

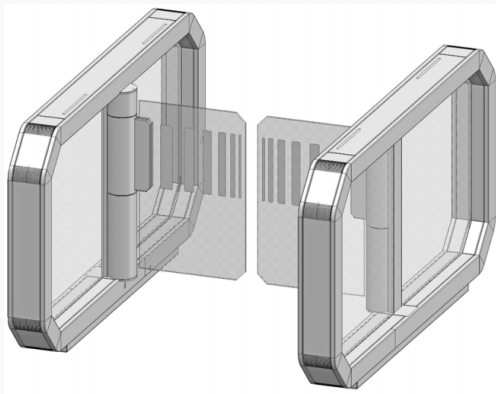

### Galaxy-Gate

- Gate ~ FMCU Galaxy Gate ~ Prospekte
- Gate ~ FMCU Galaxy Gate ~ Access Manager
- Covcheck Applicaton Server
- Gate ~ FMCU Galaxy Gate ~ Benutzerhandbuch
- Gate ~ FMCU Galaxy Gate ~ Bedienungsanleitung
- Wanzl Zutrittsmanager ~ Verwaltungs-Dashboard
- Gate ~ Inbetriebnahme
- Gate ~ FMCU ~ Checkliste

## Akku



### Li-ion Battery

- Li-ion battery ~ batterypack ~ user manual
- Li-ion battery ~ inverter ~ user manual
- Li-ion Batterie ~ Wanzl-100l Ladegerät ~ Bedienungsanleitung

## KT-Drive

|   |  |
|---|--|
|  | <b>KT Drive</b>  |
|   | <ul style="list-style-type: none"><li>■ <a href="#">KT drive ~ user manual</a></li></ul> |

**POS**

|   |            |
|---|------------|
| <br>POINT OF SALES | <b>POS</b> |
|   |            |

**Kamberi Group**

|   |   |
|---|---|
| <br>KAMBERIGROUP | <b>Kamberi Group</b>  |
|   | <ul style="list-style-type: none"><li>■ <a href="#">Arbeitsabläufe Videos</a></li><li>■ <a href="#">Arbeitsabläufe der Kamberi-Gruppe</a></li><li>■ <a href="#">Bedienungsanleitung</a></li></ul> |